



London Mayfair Office
 Cashel House
 15 Thayer Street
 London W1U 3JT
 Tel: 020 746 75330
 londonoffice@pymmand.co.uk

Brundall Office
 76 The Street
 Brundall, Norwich
 Norfolk NR13 5LH
 Tel: 01603 717717
 brundallhomes@pymmand.co.uk

Thorpe End Office
 67 Plumstead Road
 Thorpe End, Norwich
 Norfolk NR13 5AJ
 Tel: 01603 300066
 thorpeshomes@pymmand.co.uk

Costessey Office
 68 Longwater Lane
 Costessey, Norwich
 Norfolk NR5 0TH
 Tel: 01603 744359
 costesseyhomes@pymmand.co.uk

Lettings Head Office
 2-4 Ber Street
 Norwich, Norfolk
 NR1 3EJ
 Tel: 01603 305805
 lettings@pymmand.co.uk

City Centre Office
 2-4 Ber Street
 Norwich, Norfolk
 NR1 3EJ
 Tel: 01603 305805
 homes@pymmand.co.uk

Our expert mortgage advisors are able to guide you through the whole mortgage process, to help you select and arrange the right product for you. Let us also make your life easier, by arranging the selected mortgage on your behalf. This includes First Time Buyer, Home Mover, Re-mortgage and Buy to Let services.

Broadland Consultants Limited is an Appointed Representative of Financial Limited Which is Authorised and Regulated by The Financial Services Authority, FSA No 521208. * Your home may be repossessed if you do not keep up the repayments on your mortgage.

BROADLAND CONSULTANTS LIMITED
Looking for a mortgage?
 Independent Mortgage & Financial Advice.



TOTAL APPROX. FLOOR AREA 77.7 SQ.M. (836 SQ.FT.)
 Measurements are approximate. Not to scale. Illustrative purposes only. Creator of plan ALPHA EPC.
 Made with Metropix ©2016

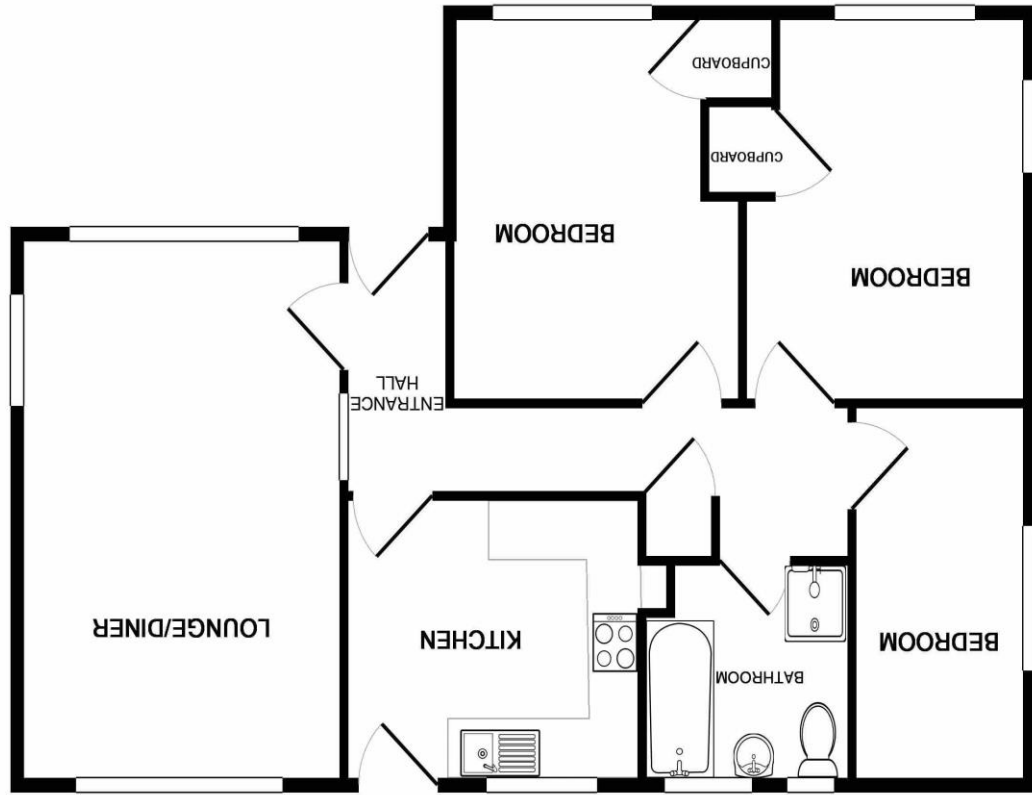

Pymm&Co
 Estate Agents and Lettings

A three bedroom detached bungalow located in a cul-de-sac on a good size plot in the much requested suburb of Hellesdon. The accommodation is arranged to provide entrance hall, lounge, kitchen, three bedrooms and a bathroom. The property benefits from having gas central heating and double glazing. Externally there is ample off road parking, detached double garage and front and rear gardens. An early viewing is highly recommended.

£265,000

**52 Brabazon Road, Hellesdon,
 Norwich, Norfolk, NR6 6SZ**

Call 01603 305805 | www.pymmand.co.uk



Property details

Obscured double glazed entrance door to:-

Entrance Hall

Doors to all rooms.

Lounge

11' 11" x 18' 6" (3.62m x 5.63m)

Double glazed bay window to the front, side and rear, radiator.



Kitchen

10' 11" x 9' 6" (3.33m x 2.89m)

Double glazed window to the rear, double glazed door to the rear, fitted with a range of base and wall units, work surfaces, sink unit with mixer tap over, tiled splashbacks, space for a cooker with extractor over, spaces for other appliances.

Bedroom 1

12' 11" x 10' 6" (3.94m x 3.21m)

Double glazed windows to the front and side, radiator.



Bedroom 2

12' 10" x 10' 6" (3.92m x 3.21m)

Double glazed window to the front, radiator.

Bedroom 3

13' 0" x 6' 4" (3.95m x 1.93m)

Double glazed window to the side, radiator.



Bathroom

Obscured double glazed windows, bath with mixer tap and shower attachment, shower cubicle, vanity wash basin, low level WC, tiled walls, heated towel radiator, tiled floor.

Outside

To the front there is a brickweave driveway providing ample off road parking with a lawned area and pathway to the front door. double gates to the brick built detached garage with up and over door. The rear garden is enclosed and laid to lawn with a range of plants, trees and shrubs, patio area, greenhouse and vegetable garden.

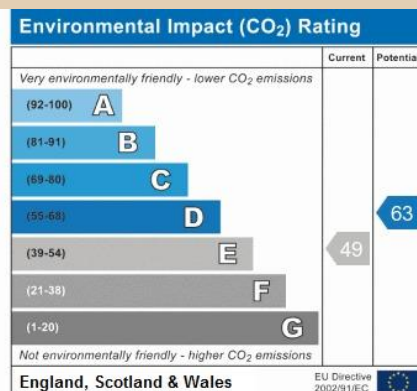
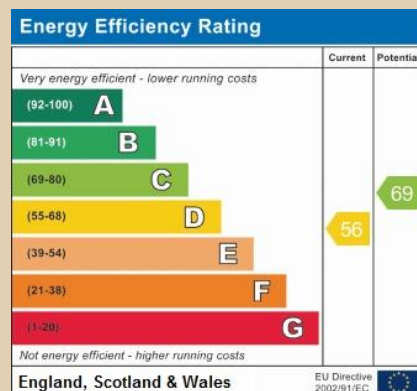

Please note that we have not tested any apparatus, equipment, fixtures, fittings or services, and so cannot verify they are in working order and are fit for purpose. Furthermore our measurements are for an indication only and should not be taken as fact. Solicitors should confirm moveable items described in the sales particulars are, in fact, included in the sale, since circumstances do change during marketing or negotiations.

Lettings & Property Management

Are you looking at this property as a buy to let investment? If you would like any help regarding the letting and management of this or any other property, our ARLA regulated lettings department are always happy to help.

Please call 01603 305805